



Assembly Instructions
wireSENSOR

Precautionary Measures

- Do not open the sensor housing.
- Do not pull or loop the measuring wire around unprotected parts of the body.
- Do not pull the measuring wire over range.
- > Danger of injury
- Do not damage the measuring wire.
- Do not oil or grease the measuring wire.
- Do not bend the measuring wire.
- Do not pull the measuring wire at an angle.
- Do not allow to loop the measuring wire around objects.
- Do not let the measuring wire rewind without control (snap back).
- Fix the measuring wire to the target when wound up only.

Sensor Assembly

- Series Z60: 2x M4 screws DIN 931
 - Series P96: 4x M6 screws DIN 931 and 2 groove stones
 - Series P115: 4x M6 screws DIN 931 and 2 groove stones
 - Series P200: 4x M8 screws DIN 912 and 4 groove stones
- The sensor does not have to be oriented in a special way.
 Choose the installation position so that damage and soiling of the measuring wire is avoided.

Proper Environment

- Protection class of sensor: IP 65
- Operating temperature: -20 to +80 °C (-4 to +176 °F)
- Storage temperature: -40 to +80 °C (-40 to +176 °F)
- Humidity: 5 - 95 % (non-condensing)
- Ambient pressure: atmospheric pressure
- Vibration: according to IEC 68-2-6
- Mechanical shock: according to IEC 68-2-27

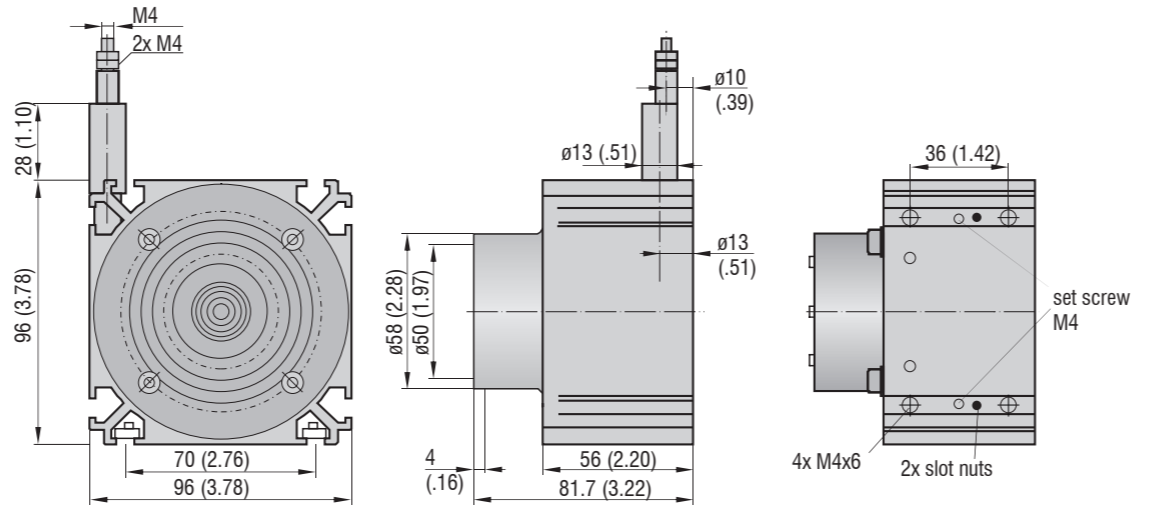
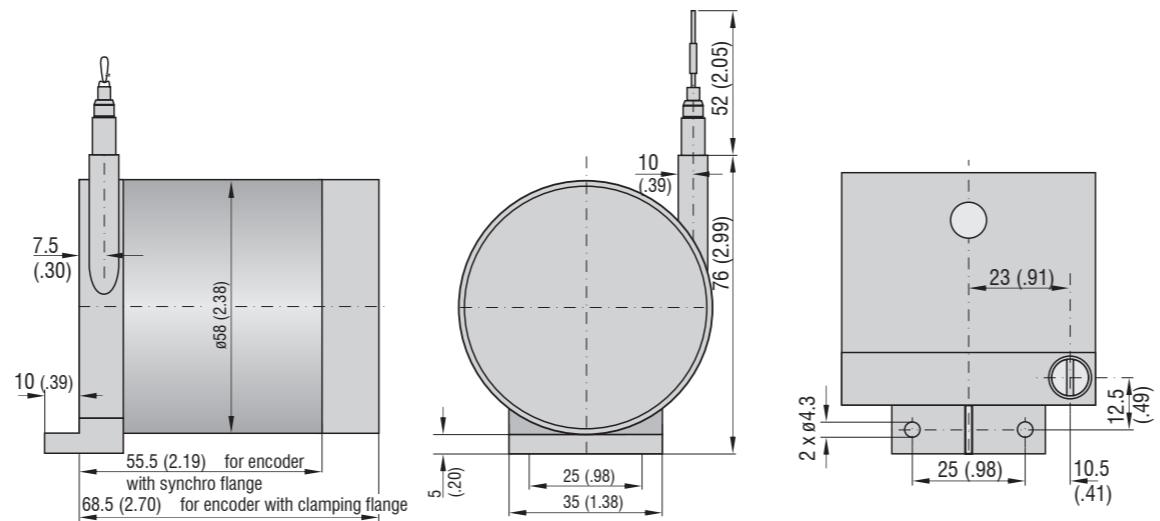

Installing the Encoder

- ▶ Make sure that the measuring wire is always tensioned by the spring motor in order to prevent it from jumping off the pulley.

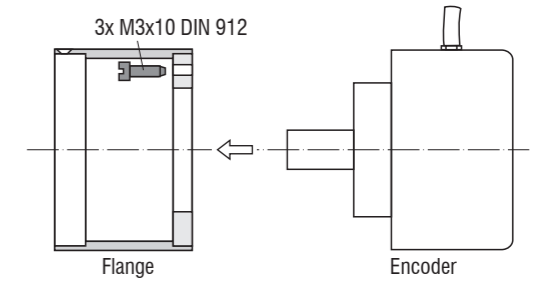

Mounting of adapter flange and encoder, Series WDS-Z60

- ▶ Mount the encoder/adapter flange assembly on the draw-wire mechanism.
 - ▶ Fasten the coupling and the encoder shaft with the supplied hexagon socket screw. Press the supplied cap into the opening in the adapter flange housing.
- i** Make sure that the encoder shaft is not rotated during installation!
 Follow the installation instructions issued by the manufacturer of the encoder.

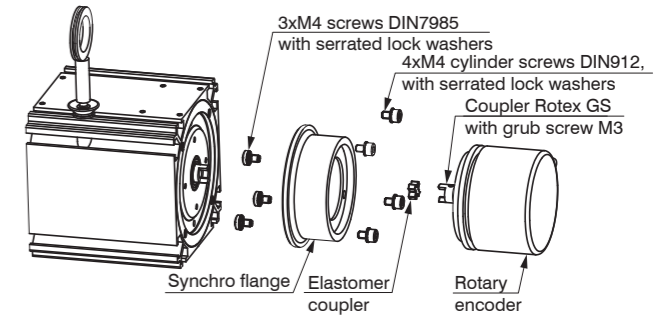

Mounting of adapter flange and encoder, Series WDS-Pxxx



